

2011 BHC Annual Report

Building today to sustain tomorrow

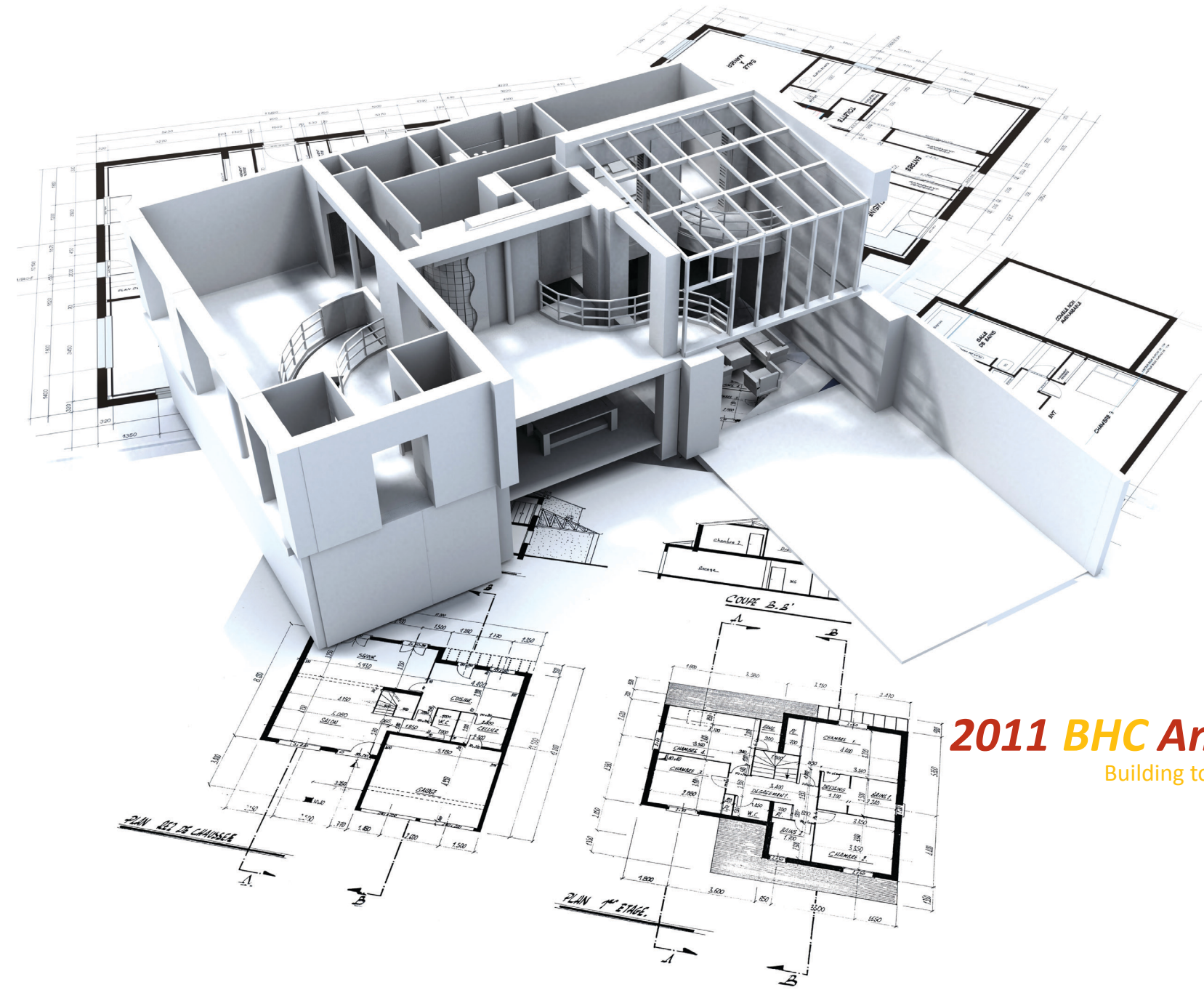

2011 BHC Annual Report
Building today to sustain tomorrow

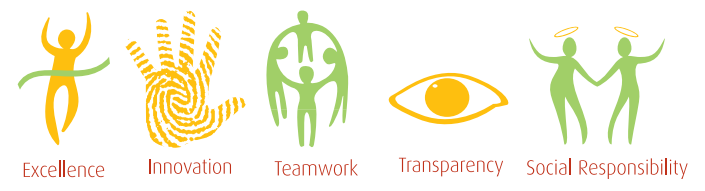

Excellence Innovation Teamwork Transparency Social Responsibility



BHC Offices Contacts

Property Sales Office

Molosiwa Road
P O Box 1197
Gaborone
Tel: +267 395 2431/364 6800
Fax: +267 395 6649

Property Management and Maintenance Office

Lejara Road
P O Box 168
Gaborone
Tel: +267 391 2335/364 6800
Fax: +267 397 5931

BHC Call Centre

Tel: 1167 (BTC Landline Only)
Tel: +267 315 9902

Lobatse Office

Pitikwe
Ponatshego Mokane Street
P O Box 284
Lobatse
Tel: +267 533 0460
Fax: +267 533 3652

Jwaneng Office

Pick n' Pay Shopping Complex
Unit 1
P O Box 25
Jwaneng
Tel: +267 588 0214
Fax: +267 588 1755

Mahalapye Office

Flowertown
Plot 617
P O Box 1231
Mahalapye
Tel: +267 471 1747
Fax: +267 471 3925

Palapye Office

P O Box 894
Palapye
Tel: +267 492 1075
Fax: +267 492 1076

Selebi Phikwe Office

Industrial
Ramotswa Drive
P O Box 133
Selebi Phikwe
Tel: +267 261 0569
Fax: +267 261 0814

Francistown Office

P O Box 603
P/Bag F120
Francistown
Tel: +267 241 5080
Fax: +267 261 0814

Kasane Office

Plateau
Plot 1148
P O Box 337
Kasane
Tel: +267 625 0146
Fax: +267 625 0146

Maun Office

Chobe
Lekukara Road
Plot 3064
P/Bag 00124
Maun
Tel: +267 686 0637
Fax: +267 686 2251

Head Office

*Plot 4773
Corner Mmaraka & Station Roads
PO Box 412
Gaborone*

*Tel: +267 360 5100
Fax: +267 395 2070*

